

 EMTELLE

 RTRYVA™

RETRACTABLE PRE-INSTALLED FIBRE SOLUTION

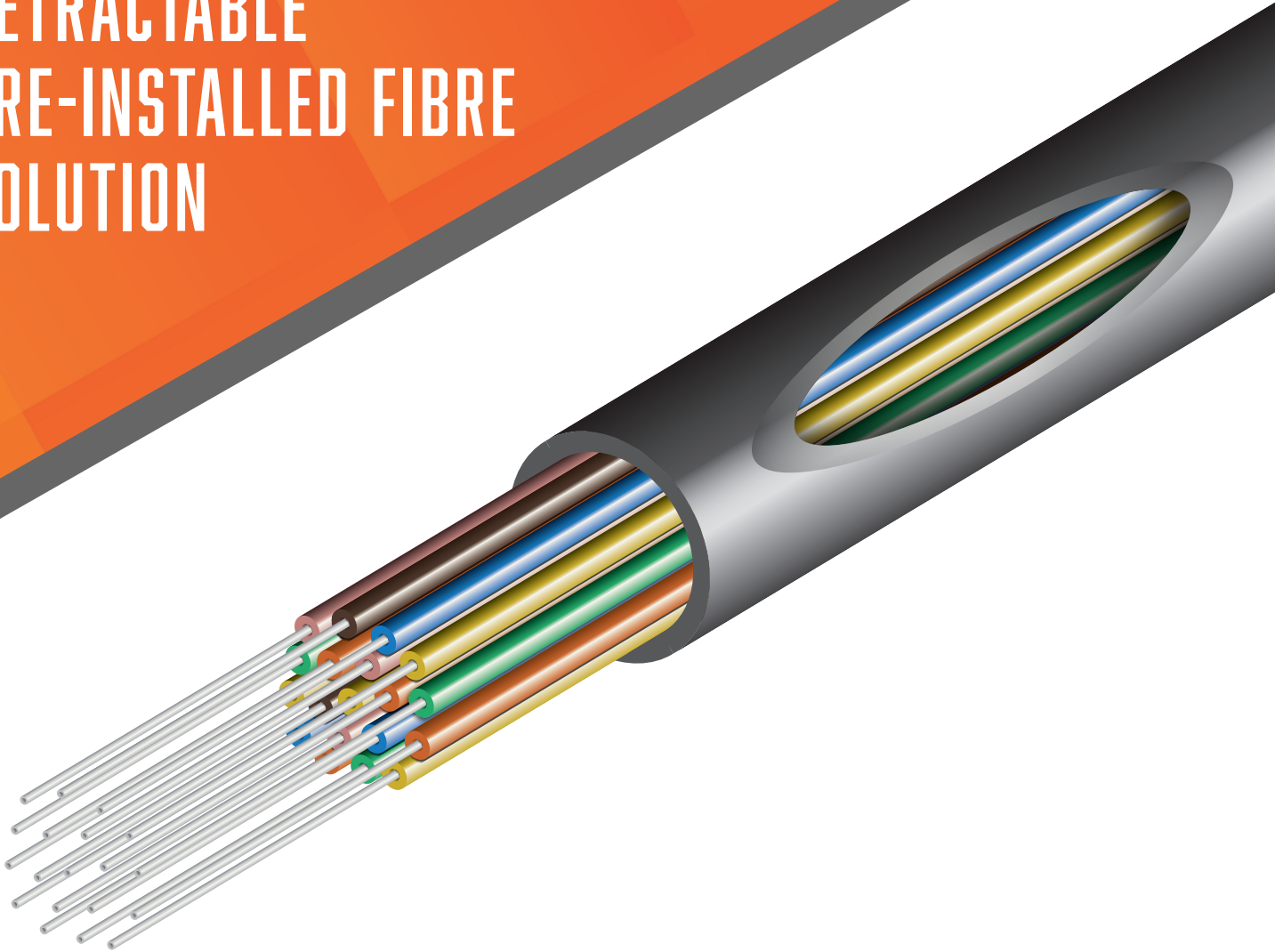

Pre-installed fibre within a loose tube bundle

Flexible sheath to allow for easy access of desired microduct

No fibre blowing required

Emtelle RTRYVA is a high-density fibre pull back cable constructed of pre-installed loose fibre units, protected within a PE microduct. RTRYVA offers a solution where duct access and branching from the solution is quick and easy, using minimal amount of tool, training and installation equipment.

To access the desired fibre, a simple window cut is made, the fibre unit is pulled back out and branched to the home through a dedicated drop duct without the need for using connectors. The Emtelle EMU box can be used to breakout and distribute the fibres from the RTRYVA solution Fibre installation to inside the home is carried out by pushing or pulling.

Note: this solution is also available in LFH material for internal use, giving excellent performance in a fire scenario

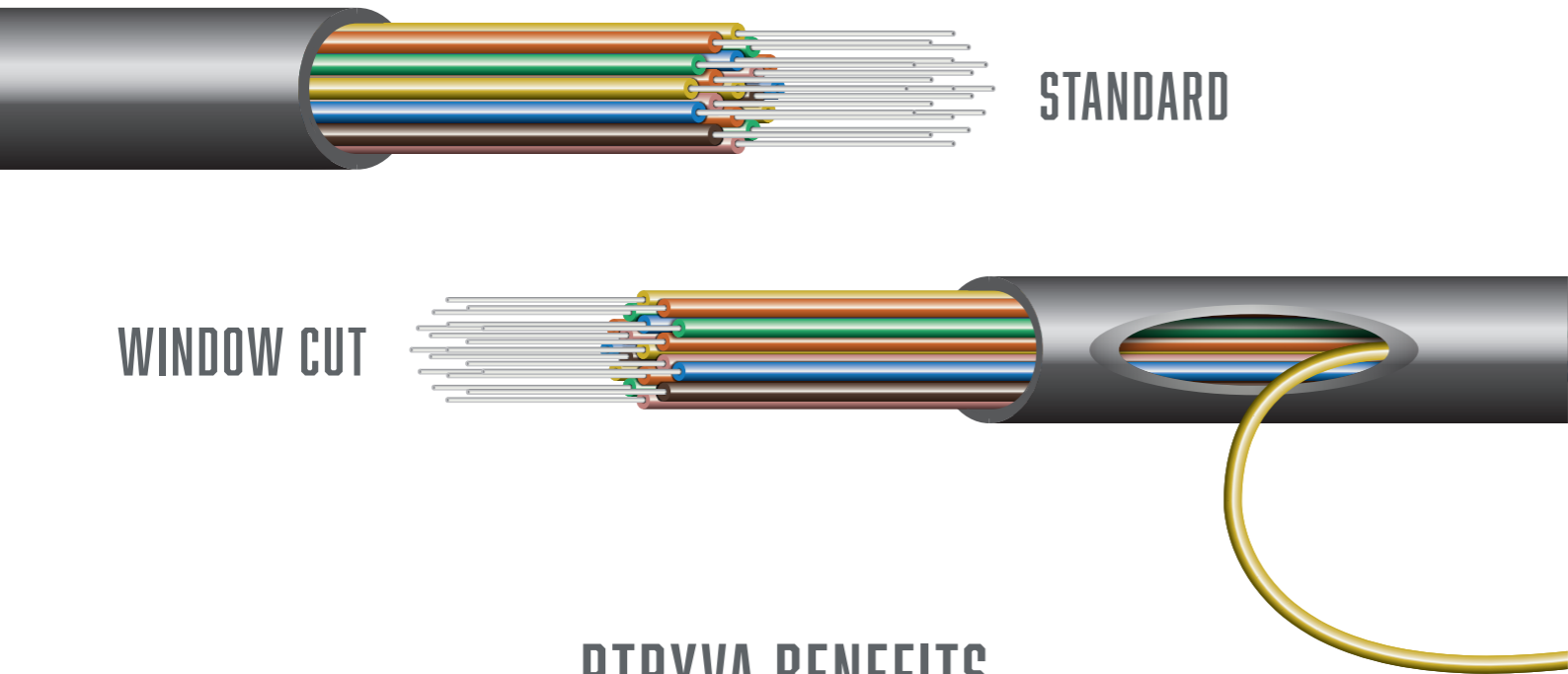

RTRYVA BENEFITS

- Fibre tubes (within the RTRYVA) can vary from 2-12 fibres per tube
- High speed installation and connectivity with no specialist training
- No blowing equipment required
- GRP strength members to offer additional strength and longevity
- A simple to install drop closure to the home (4 drops per closure)
- Drop tubes can have pre-installed draw string to aid fibre installation to the home
- 4-8 times more fibre drops can be made from an existing 32mm, or 1¼ HDPE duct compared to traditional cables
- A mix of fibre counts is available for your specific requirements



RTRYVA VALUE PROPOSITION

30M TO 150M
PULL BACK
DISTANCE

NO BLOWING
REQUIRED

OVER 35% SAVINGS
COMPARED TO
RTRYVA **HDPE**



1

Using a white paint marker pen, mark out the length of the window cut.

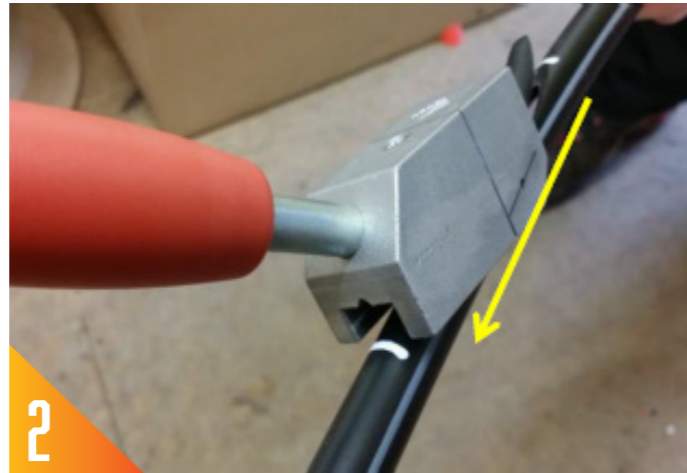

2

Pull the tool towards your body, when the back of the tool reaches the second mark start to lift the back of the tool.



3

When lifting the tool, do not pull straight up, lift the handle forward as the tool is pulled back this will give a tidy window cut.



4

Window cut complete.



5

Seal off the RTRYVA appropriately and push the RTRYVA into place within the EMU Closure.



6

Seal the microducts and put in place within the EMU Closure.



7

The fibres can now be selected to be pushed or pulled back to the desired drop microduct.

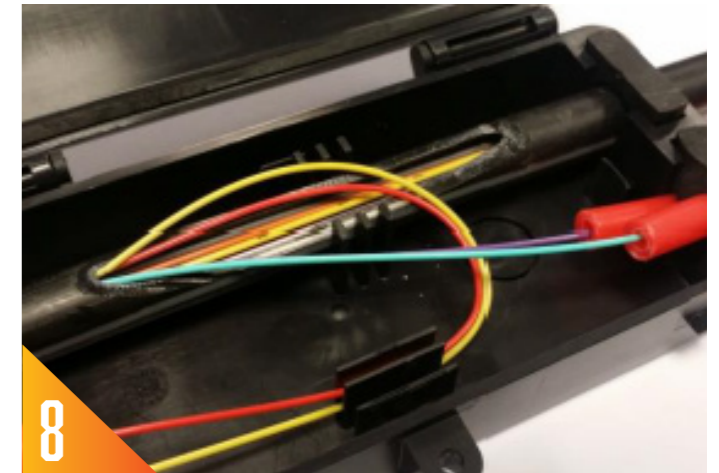

8

The fibre can be pulled back using a pull cord or pushed up to 50m by hand.

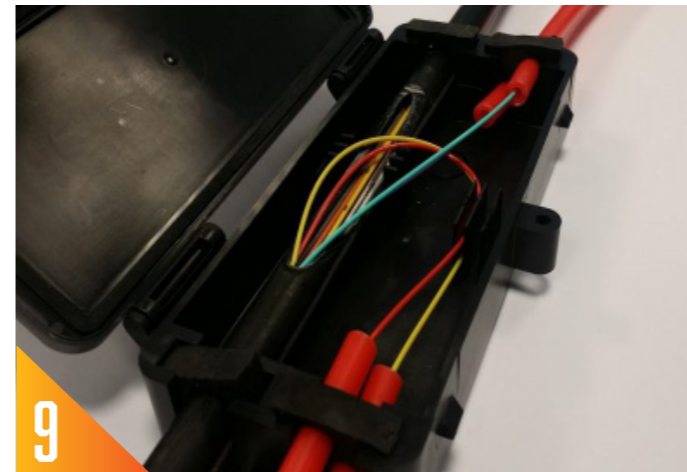

9

A completed closure.



DATA SHEET
SCAN HERE
←←



CONTACT US

Emtelle Group

Allan House, Floor 4
25 Bothwell Street
Glasgow, G2 6NL
United Kingdom

 **+44 (0) 1450 364 000**
 **info@emtelle.com**

Emtelle Hawick, UK

Haughhead
Hawick
TD9 8LF
United Kingdom

 **+44 (0) 1450 364 000**
 **info@emtelle.com**

Emtelle Jedburgh, UK

Oxnam Rd
Jedburgh
TD8 6NN
United Kingdom

 **+44 (0) 1450 364 000**
 **info@emtelle.com**

Emtelle Ridgemount Technologies Ltd

Unit 5, Field Farm
Business Centre,
Launton, OX26 5EL
United Kingdom

 **+44 (0) 1869 277 233**
 **ridgemount.info@emtelle.com**

Emtelle Scandinavia

Vardevej 140
7280 Sønder Felding
Denmark

 **+45 86 28 84 88**
 **salg@emtelle.com**

Emtelle GmbH

An der Flurscheide 20
99098 Erfurt
Germany

 **+49 (0) 361 654 330**
 **info-de@emtelle.com**

Emtelle UAE

Plot KHIA8-126, 127, 128
Taweelah
Abu Dhabi
UAE

 **+971 4 883 1608**
 **info@emtelle.com**

Emtelle USA

101 Mills Gap Rd
Unit A, Fletcher
NC 28732
USA

 **+1 (828) 7079970**
 **info@emtelle.com**

